

RENATO GAMBA™



Italian fine shotguns



*Knight Renato Gamba
by appointment of Royal House*

A producer not only wants to commit himself to make a shotgun or rifle of the highest order, but inspire into these objects a certain spirit and personality. His catalogue, therefore, cannot be just a simple listing of his products. It is my intention within this book to not only show the fine firearms connoisseur what we make, but why and how we make it the way we do. In order to



explain why I make shotguns like the Daytona, or rifles like the Maxim, it would not be enough to just say they are fine firearms. I want to convey the fact that they are not only highly technologically designed, skillfully manufactured and beautifully decorated but are a part of myself, an obsession if you will.

I was born into a gunsmiths family where together with the mother's milk they began immediately to teach me the how and why of our work. A work to which I am fiercely attached and which I am very proud to do. It is the kind of work which can only be done with and out of passion, or rather with love.

Renato Gamba

The Gamba Family



As far as it is known from available documents, the Gamba family came to the Gardone area from Bergamasco in the first half of the 18th century. Considering that a lot of famous families of barrel producers came to the chief town of Val Trompia during this time period, areas where there was important metallurgical activity, it seems safe to say that the Gamba family was originally from the Val Brembana and certainly already active in iron production.

The insertion of the Gamba family in the area surrounding Gardone followed quickly and completely and, on the 5th of June, 1748, Giuseppe Gamba di Giacomo married Maddalena Belleri.





Belleri was an ancient family of local gunsmiths, and the witnesses were Giuseppe Beretta (son of Ludovico) and Vincenzo Cominazzi. The

relationship with these famous families permitted the Gambas to build up blood ties with those who represented “the best of the best” in barrels production. With these families we remember the marriage between Giuseppe Gamba and Giulia Bernardelli, (Giuseppe and Giacomo were, in the past, the most common names given to the sons of a family). What followed is yesterday’s history. Today the continuity of the tradition is entrusted to Renato Gamba and his son Enrico Gamba.

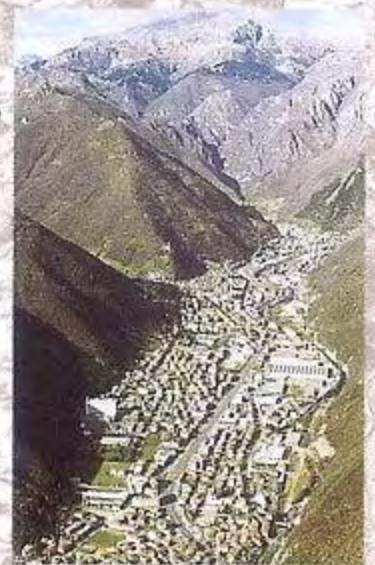

RENATO GAMBÀ



Renato Gamba shotguns are my passion

We have always been involved in the manufacturing of fine shotguns. These guns are built and finished by skilled craftsmen who must follow the Rules of Art, look after the execution, the performance and carry these points out to the finest detail. These artisans, when beginning a fine arm must consider material, mechanical workings, design as well as aesthetics. The last point should not only be personal and refined, but must also translate the technical and formal content of the object without bending to the rigid laws of ergonomics. It must be done in a way that the relationship between man and shotgun combines the users comfort, the ballistic yield and the performance in the field, be it hunting or sport shooting.

A fine arm can be an object with a high degree of technological content and substance, but it cannot pre-desend from man's contribution. Man is the only one who can, thanks to his taste for beauty, add to a fine arm in a dramatic way with his eye for the beautiful and majestic. He can distinguish it from another maybe highly successful model in terms of technique and ballistics even though it still remains a simple thermodynamic machine or an object without any kind of personality.

But, if machines are only used to "rough shape" the material and the following work is to 60 percent entrusted to the hands of authentic Artists, then a shotgun is no longer simply "fine" but it becomes a unique and unrepeatable piece of Art Work.

A Work of Art that is evident and obvious





Tradition and progress

To build a shotgun, especially a fine shotgun, is something that even today is done following methods that were perfected more than a century ago. But, if it is not supposed to be an object destined only to a very few fortunate people, then the existence of our product (the shotgun) had to completely change. The technological progress has shifted the accent from technical know-how to design. The different types of steel, the latest knowledge regarding termic and chemical-physical treatment of the materials, and the revolution in production methods, especially the production with CNC machines can all be used in different ways.

We understand these new technological pro-

The precision CNC machine at work milling a Daytona action with rows of finished actions in the foreground. From this point all work is completed by hand



new
TRIGGER GROUP





testimony of the passion, along with inspiration and capacity to accomplish what is to everybody a real masterpiece. In the product line of "Renato Gamba" there are only fine arms, including highly technological ones, where the craftsman's hand takes the place of the CNC machine. Everytime this guarantees better results, accomplished to a large part thanks to the instruments that are guided by the most sensible and sophisticated control systems ever invented: the one formed by the fingers and the brain of a man.

With the fitting of wood to metal, stocks made of selected walnut and root walnut, highest quality hand made engravings by famous masters, the pureness of lines and all of the quality technical and formal aspects, we build some of the finest guns available in the world today.

We do not propose to build shotguns for all pocketbooks, but we do guarantee to always offer products with an excellent ratio of quality and design for the price.

Add on top of that the added value of a unique and unrepeatable style. From the mid-range side-by-side or over-and-under shotguns for sport or hunting, to the unique examples destined only to the more refined tastes, the shotguns which bear the name of Renato Gamba are always a winning choice. They also have the added advantage of being the product of a perfect marriage between advanced technology and traditional craftsmanship.

These guns bear on their shoulders the centuries of experience which has made Val Trompia, Italy a forge of master arms builders unique in all the world.



*The master engraver
Angelo Galeazzi at work*



*Skilled craftsman
at work in the factory*



gresses as a way to produce firearms without compromise. This allows us to build guns with the best performance and materials and at the same time make them accessible for most people. Our arms, including those with even the most extreme mechanization of production are never allowed to become anonymously mass produced objects, but can be proud of formal care, a strong personalization, and an overall finish which only the hands of a skilled craftsman can accomplish.



Renato Gamba

Daytona K2 THE WINNER'S CHOICE

With newly designed interchangeable and detachable trigger group "patented by Gamba"

- Trap
- Skeet
- Hunting
- Sporting clays
- Double trap
- ZZ Bird electrocibles

new

26TH TIMES
WORLD
CHAMPIONS



Born from the beginnings as a true competition shotgun the Daytona is becoming a dominant force in all of the different shooting disciplines as well as for hunting. These are guns

which are different as far as the role is concerned that they are supposed to play but the "heart" is identical for all the over and under shotguns called "Daytona", as well as the attention which is paid to the choice of the material, the production and the assembly. An over-and-under shotgun is built around its action body and the Daytona is built around a very exceptional one. Made of special heat treated steel and manufactured on CNC machines, it has the "Boss" locking system. This locking system is extremely refined, and difficult to carry out but, it guarantees the perfect lines, speed in opening and closing of the barrels and, first and foremost, indestructible and extremely durable lock up. The Daytona action body is the shallowest from the rib to the trigger plate available.



Lesley Goddard UK
Trap Champion



Bart Brighenti
Australian
National Sporting
Clays Champion
for 2005

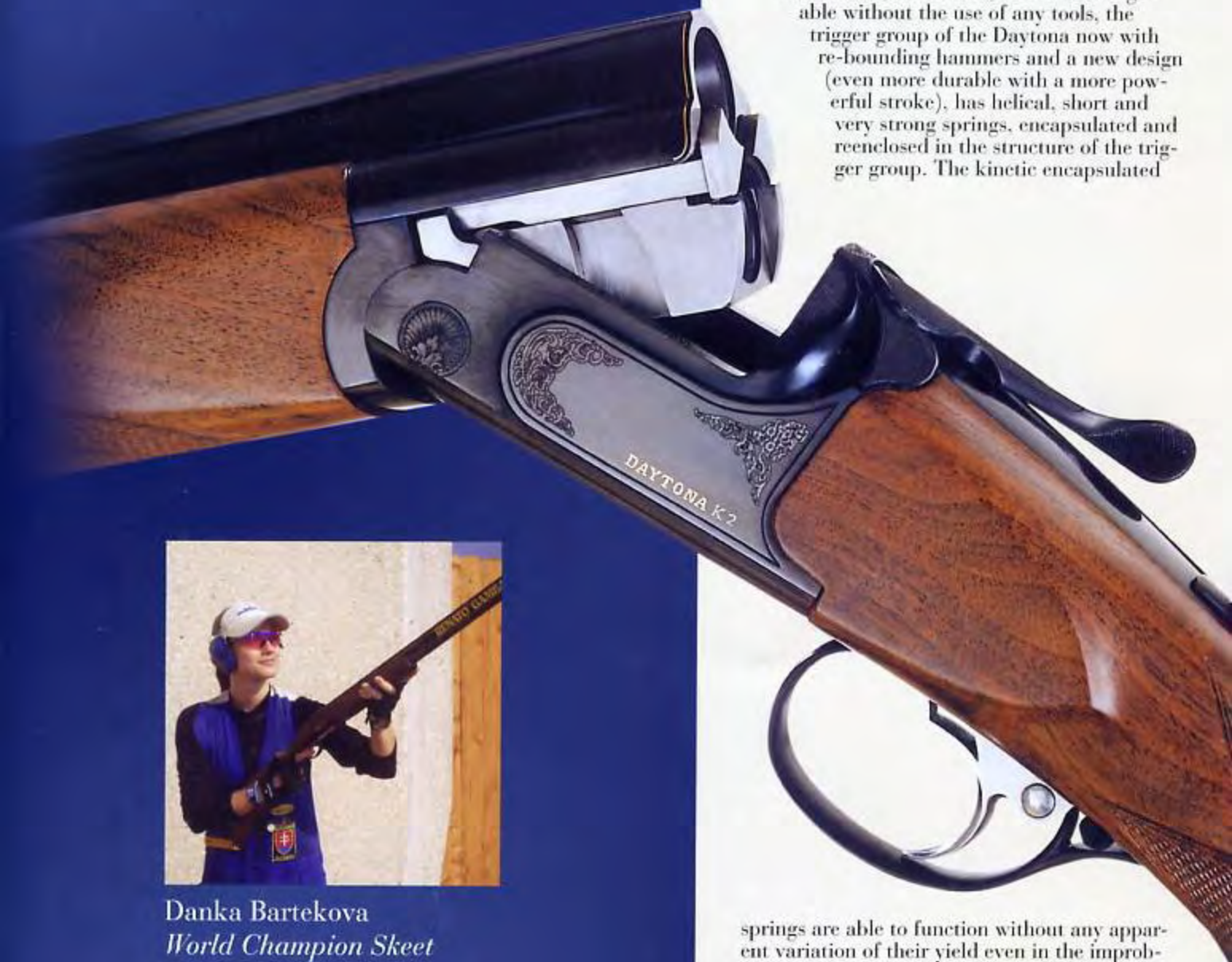

The refinement of the design demands very careful execution and where the CNC machines cannot do the best then they give way to the hands of the skilled craftsman. On the Daytona the craftsman has the very delicate task to unite in perfection the "Boss" locking system to the corresponding mortises in the action body. This is very delicate work, which only the best are able to do correctly, but when this is done in a correct way, it will guarantee a sound and durable lock up even with heavy cartridges. The "Boss" locking system is truly the "queen" of all systems used and is reserved for only the most refined over-and-under shotguns.

The action body of the Daytona houses the most important element of the gun; the trigger group.

Detachable, removable, and interchangeable without the use of any tools, the trigger group of the Daytona now with re-bouncing hammers and a new design (even more durable with a more powerful stroke), has helical, short and very strong springs, encapsulated and reenclosed in the structure of the trigger group. The kinetic encapsulated



Danka Bartekova
World Champion Skeet



Charlotte Kerwood
*Gold Medal Commonwealth
Game Australia
Trap Bronze Metal in Cairo*

springs are able to function without any apparent variation of their yield even in the improbable case that one of them should break. In addition, the re-bouncing hammers and the firing pins with antagonistic springs eliminate firing pin drag on the head of the shield as is so common on other over-and-under shotguns. The rapidity and quickness of our trigger groups "fail-safe" are well known and we feel that there is no other trigger available that can perform better, whether coil springs or leaf springs. Always being on the cutting edge of technology and convinced that the shooter should have the right to choose what type of trigger will best fill his requirements we now offer two types. Together with the trigger group with kinetic helical springs, we also optionally offer a trigger group with kinetic leaf springs. This new trigger group is completely interchangeable with the first one, with which it has many component parts in common.



Grado 7

Daytona *the shotguns* *collection* *the engraving*

A shotgun like the Daytona is not a simple thermodynamic machine built only in order to destroy clay targets. Whoever buys one wants a maximum of performance and expects a user friendly shotgun which has all of the characteristics for good shooting. In addition to this, the obvious, they want it to be beautiful, well built and well finished. When you own a Daytona shotgun you are reflecting your own personality and you will have a proud possession to show all of your friends as well as to admire alone in silence. The Daytona is offered in 8 different levels of engraving to suit every style and budget. English scroll, chisel, burin, with gold inlays: whatever the subject, the production technique or the design may be, the engravings of a Daytona shotgun are always the work of asserted master engravers. Names like Galeazzi, Torcoli, Rizzini, Tomasoni, Dassa, Gamba and others are all used. This catalog shows a rather wide range of styles available but if you still desire something different, all you need to do is ask.



Grado 4 EAGLE

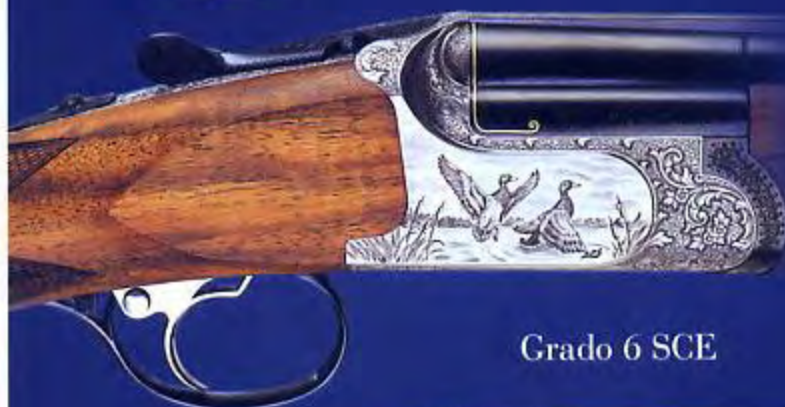

Grado 6 SCE



Grado 4 LUX

All of the Daytonas have stocks made of selected walnut (Turkish or French) with fine hand checkering, oil or gloss finish, with beavertail or schnabel forends following the speciality to which the gun is destined. There are various types of stocks with different butt pads available. Drops at the comb between 29 mm and 33 mm and at the heel between 38 mm and 42 mm are considered standard and are included in the price.

Other options would fall under the category of stocks made to measure where the stock is, in the same way as a tailormade suit, literally made to the measure of the shooter. It should also be noted that the engraved Daytonas all have stocks made of very selected walnut.

Grade "B" is normally used on standard guns but grade "C" is much warmer and iridescent with more prominent grain visible. After type "C" the wood is no longer just selected walnut but the finest selected root walnut available. Stocks of this material, indicated with the grading of "D" are used on the special versions of the Daytona SL and SLHH. For that very special shotgun it is even possible to go up to stock grade "E" or "Exhibition" as it is often referred to. As it has been mentioned above, different types of stocks are available for the Daytona, including an adjustable model. All the Daytona stocks are easily replaceable and the special tool for the rapid disassembly is delivered in the ABS plastic or leather travel case that each Daytona comes in.



Grado 7 bottom



Grado 6



Grado 5 - Grado 5E without gold

SL Grado 2

SL Grade 2 left side

Daytona SL *total elegance* *for sport and hunting*

If you want an even more beautiful and slender Daytona try the SL: it is like the others but it carries side plates, on which even more beautiful engravings are carried out. On these pages we are showing the SL Grade-2 which is one of our more popular styles of higher grade Daytona. Just like its un-sideplated brothers it is available with an optional 20 gauge set of interchangeable barrels which lock on to the 12 gauge frame. This makes a wonderful competition / hunting set. Being built following the design and the rigid quality standard of the regular Daytona, the SL also has a removable trigger, BOSS type action body and special heat treated steel barrels made of chrome-nickel-molybdenum with chromed shell chamber. The monobloc breech is assembled, bored and manufactured exclusively with CNC machines yet retaining all of the know-how resulting from a tradition which can be measured in a multitude of years. The Daytona and SL are available in both 12 and 20 gauge and in barrel lengths ranging from 26 to 32 inches in either fixed or screwed in chokes for added versatility.





SL Grado 2



SL Grado 2 right side

All barrels are subjected to high pressure proof test by the National Proof House located in Gardone Val Trompia Italy. This assures the owner of a Daytona that the barrels on his gun are as good as he can get.

The triggers on the Daytona shotgun are single in either selective or non-selective. Also optionally available on demand is the selective trigger.

Standard triggers are always anatomic but may be ordered adjustable with a range of movement of up to 25 mm. One should be particularly aware of the ballistic yield or elasticity built into our barrels.

This along with the low profile receiver, grip design and stock bolt angle leads to a strong reduction in recoil and muzzle jump. This enhances recoil recovery for a quick and precise second shot. Women find the lack of excessive recoil to their liking especially when teamed with cartridges of 28 grams of lead.



RENATO GAMBA™

Daytona SL

*the Michelangelo
of shotguns*

The SL is a superb shotgun, but the technical characteristics of this arm are not the total aim in itself but rather serve in order to enable what becomes a luxurious tri-dimensional canvas on which master engravers can give free play to their very art. In addition to the SL Grade 3, a very refined engraving combining English scroll with game scenes, there are 7 different styles available. The first studied variation in the "Grade 1 Oro" characterized by engravings showing hunting scenes with 24 karat gold inlaid subjects. Next comes the Grade 2 which can be seen on the previous 2 pages. We also have an elegant English scroll engraving called "Inglesina tipo Purdey" and the "Royal" engraving honouring the English H&H royal scroll.

Now we are coming to the top of the range with the name of the model passing from Daytona SL to Daytona SLE. The first model is called the "SLE Tiger" which has African game scenes of animals. All of the above guns come standard with grade "C" wood. Standard with grade "D" wood of highly selected Turkish root walnut are the "SLE Venus" showing the hunting "Goddess Diana" and then the model "SLE The Best". This gun is truly the epitome of firearm Art with its detachable sideplates and 24 karat inlaid gold animals and game scenes. The engravings of the SL are further continued in the variations of the SLHH model of the Daytona, some of them being shown on the following two pages.



RENATO GAMBA™



SLe Tiger





Grado 3



Grado 1



The nobility of the sidelock

The Daytona is a boxlock shotgun and although it is one of the finest, the very idea of the high prestige shotgun rests very closely to the sidelock, standardized by the firm of Holland & Holland of London. To this day almost all sidelock guns are described as the H&H Type. Actually, a lot of the sidelocks which have been developed after those of the House on Bruton Street were never really innovated, limiting themselves to refining or improving one or several details. To this fact only a very few sidelocks really made an exception to this design. One of those is the one invented by Renato Gamba for his Maxim Express rifle. This action has the intention to develop a sidelock which in comparison to the H&H boasts less fragility and faster lock times. All of this was achieved without any loss in terms of safety and was therefore obligated to offer the equivalence of the double safety which, on the H&H, interrupts the hammer in case of accidental release of the sear. All of these objectives are fulfilled by this sidelock with linear moving hammers and double safety sears, which today represent a kind of brand





mark for the most exclusive shotguns built by "Renato Gamba". The Gamba sidelock together with monobloc barrels and anti-glare hand matted rib, are the elements that distinguish the Daytona SLHH from the other Daytona models. In this gun is still the "beating" of the technological heart of the Daytona, but the ultimate technical and formal refinement and the high manual intervention by the best craftsman make the SLHH a classic example of "Extreme Architecture" in high grade shotguns. With the above exception, the layout of the SLHH is just like that of the other Daytona models. In the SLHH Daytona there are sporting and hunting models available in 12 and 20 gauges as well as 28 gauge. They are available with all of the possibilities of choice and personalization that are due to such a refined product.

These possibilities include, of course, the engravings that have been shown on the Daytona SL/SLE. On the following pages are represented the other engraving styles to choose from, including the "1 of 1000".



RENATO GAMBA™

SLHH One of Thousand

SLHH One of a Thousand

*Daytona
SLHH
shotguns and
fine art*

The high arquebusier of the Daytona SLHH is taken to the ends of the world in the "Triple Diamond Collection" or the SLHH "One of a Thousand". The triple is formed by three matched over and under shotguns, one each in 12, 20 and 28 gauge. This set will be stocked with only the finest exhibition grade Turkish root walnut and personally selected engravings.

The "One of a Thousand" is characterized by a very special burin engraving with subjects determined by the customer. This gun truly becomes a one of a kind in every sense of the word. Engravings are carried out by only the few top select master engravers known throughout the world. Everything about this gun is done to perfection and few firearms in the world can compare. It is truly the Olympiad of figurative art.



RENATO GAMBA™



Venus



The Best





for game...
**Concorde
Round Body**
*The Purebred
with fixed
trigger group*

The similarity between firearms and motor cars is one of the most used comparisons, maybe because it is one of the most truthful.

Consider the competitions for example. Shooting just as in car-racing, a limitation of equipment will never allow the novice or the more experienced to ever reach the winners circle. There are, nevertheless some fortunate exceptions, and with a certain pride, we place the Concord among these exceptions. Being the little brother of the Daytona, it is distinguished only by the non-detachable trigger group. The Concord has been designed with the precise intention to build a shotgun which is perfect for the novice or the champion and will put either of them in the winners circle. The same thing holds true for our hunting version of the Concord, so perfectly balanced that it is a pleasure to carry in the field. The Concord action relies on the same "Boss" style locking system as the Daytona.

Again the CNC machines are used to



Concorde SL



rough out the actions and then skilled craftsmen finish the guns by hand. All of the same special heat treated steels and barrel materials are used for this model just as in the Daytona. The national proof house in Cardone Val Trompia tests every barrel before assembly is allowed to continue, guaranteeing total soundness. The Concord is available in either 12 or 20 gauge and barrel lengths ranging from 26 to 32 inches.

The Gamba patented automatic ejectors are built extra strong to ensure reliable and simple extraction of spent shells. **The Concord has been put through a 100,000 round torture test to prove reliability.** At the end of this test the gun was still synchronized and functioning perfectly. All Concord models are available with either single-selective or non-selective triggers and, on special order, adjustable for length of pull. Guns are available in versions for trap, double trap, skeet, sporting and hunting with either fixed chokes or optional screw in chokes.

The hunting version of the Concord is built slightly lighter and trimmer than the competition models to assure speed and handling in the field. The recoil reduction qualities of the Concord are the same as the Daytona again due to the ballistic yield of our barrels and low profile receiver. Accuracy and point of impact are assured due to the painstaking manufacturing process of the barrels and choke installation. Just like the Daytona the Concord may be ordered with special engravings and wood grades of "C" or higher.



RENATO GAMBA™



The queen of the forest
624 Prince
woodcock
and extra

All of the model 624 shoutguns have engraved on the bottom of the action a "Woodcock", queen of the winged birds, to whom this side-by-side is dedicated.

It is for actually hunting this prey, with its evasive flight characteristics that require strong, fast and short distance shoots, that we offer a special version of the 624 Prince. It is called the "Woodcock" and standard with 25 inch barrels and concave "Churchill" type rib. It weighs in at a scant 6 pounds approximately and is a very fast handling upland gun. All other features remain the same as the standard 624.

For the even more demanding shotgunner we offer the M-624 Extra and M-624 Lux.

The Extra is a rounded/scalloped action body which we have engraved in the classic Westly Richards relief style. This gun resembles guns costing over twice as much yet has the advantages of modern manufacture and techniques. Of course, all finish work is hand done just like all of our other guns.

The M-624 Lux is the same basic action but is engraved with game scenes in the burin style. All other options available on the standard models are also possible on these upgraded versions.



624 Prince
Beccaccia



624 Extra



The new London gold refinedly british

The modern side-by-side shotgun was born and perfected in Great Britain. Up until a quarter century ago only British game guns had names and reputations that were world renowned. Today the United Kingdom is no longer the undisputed fatherland of the fine shotgun and the small town of Gardone Val Trompia in Italy is fast becoming the Mecca for high quality deluxe game guns. No one can take away from the British their contribution to the history and development of the top end side-by-side shotgun. Even today thoughts are inevitably directed to the capital of England when thinking of the high grade shotgun. As a tribute to the great gunsmiths who have been working in the past to gain this gun its desirable reputation we have chosen the name "London".

It has been a constant name in the production of Renato Camba sidelock shotguns and has remained unchanged even though many namesake guns have.





Incisione fuori serie

London with extra engraving

Whether one is convinced or not that it is possible to improve upon the H&H system, many of the other features of the "London origin" should remain.

For instance, we continue to use true chopper lump barrels with a Purdey third fastener locking system and locking lugs on bolts.

The hand made English style stock of selected root walnut and hand rubbed oil finish remain the classic.

Our silver finished sidelock action is still hand engraved with the traditional rosette and scroll pattern so in demand.

The London is available in standard configurations of 12 and 20 gauge with 26 inch barrels, choked improved cylinder and modified or 28 inch barrels choked modified and full. The triggers are either single non selective or double. Within the standard configurations already exist various options.

However on special order, the London is available with a large range of personalized possibilities. These options range from non standard engravings and choke combinations to added gauge selections. In addition to the 12 and 20 gauges it is actually possible to order the London in 16, 28 and 410, all of them obviously with proportionately dimensioned action sizes for the cartridge. The London is delivered in a presentation leather case.



RENATO GAMBA™



Ambassador gold and black and English scroll engraving

Ambassador Inc. Gold & Black

This being the top of the Gamba side-by-side range, the Ambassador is a Gamba sidelock with linear hammer movement, double safety system, extremely fast lock time and very low trigger pull weight. The barrels are chopper lump made of Böhler steel with Purdey triple bite underlug and locking lugs on bolt. Nothing is spared on this side-by-side in order to make it a truly high class arm and the accuracy applied to its manufacture can only be defined as maniacal. The Ambassador is available in 12, 16 and 20 gauges. This being a very custom type arm, the degree of personalization available is again up to the customer.

Only the finest of materials is used in its assembly like the selected root walnut with 24 karat gold monogram shield inlayed into it.





*Ambassador
with English
scroll
engraving*

Two standard versions of the Ambassador are available which are shown on these pages. One the English scroll engraved version and also the Gold and Black version which features a deeply blued frame with 24 karat wire inlay. All Ambassadors are delivered in a handsome deluxe leather case.



RENATO GAMBA™



Gamba Ambassador Executive to the ends of the earth

Take the Ambassador, finish it, if possible in an even more outstanding way, decorate the action body and sidelocks with engravings selected by the customer and performed by some of the most celebrated master engravers and you have the recipe for the Ambassador executive. This arm is a real masterpiece and even the slightest detail receives the up most attention from famous craftsmen. On these guns nothing is left to chance or improvisation nor to machines. The single pieces are specially heat treated and then only rough cut on the machines but all of the final assembly and fitting are done by hand. It was probably possible to allow the machines to do more of the work on this gun but the man who buys a gun of this quality demands hand workmanship and we are capable of doing it better than most. **The Ambassador Executive is also available as matched pairs**, with both guns being absolutely identical or with variations only chosen by the client.

- *Ambassador with special order engraving*





Ambassador Executive

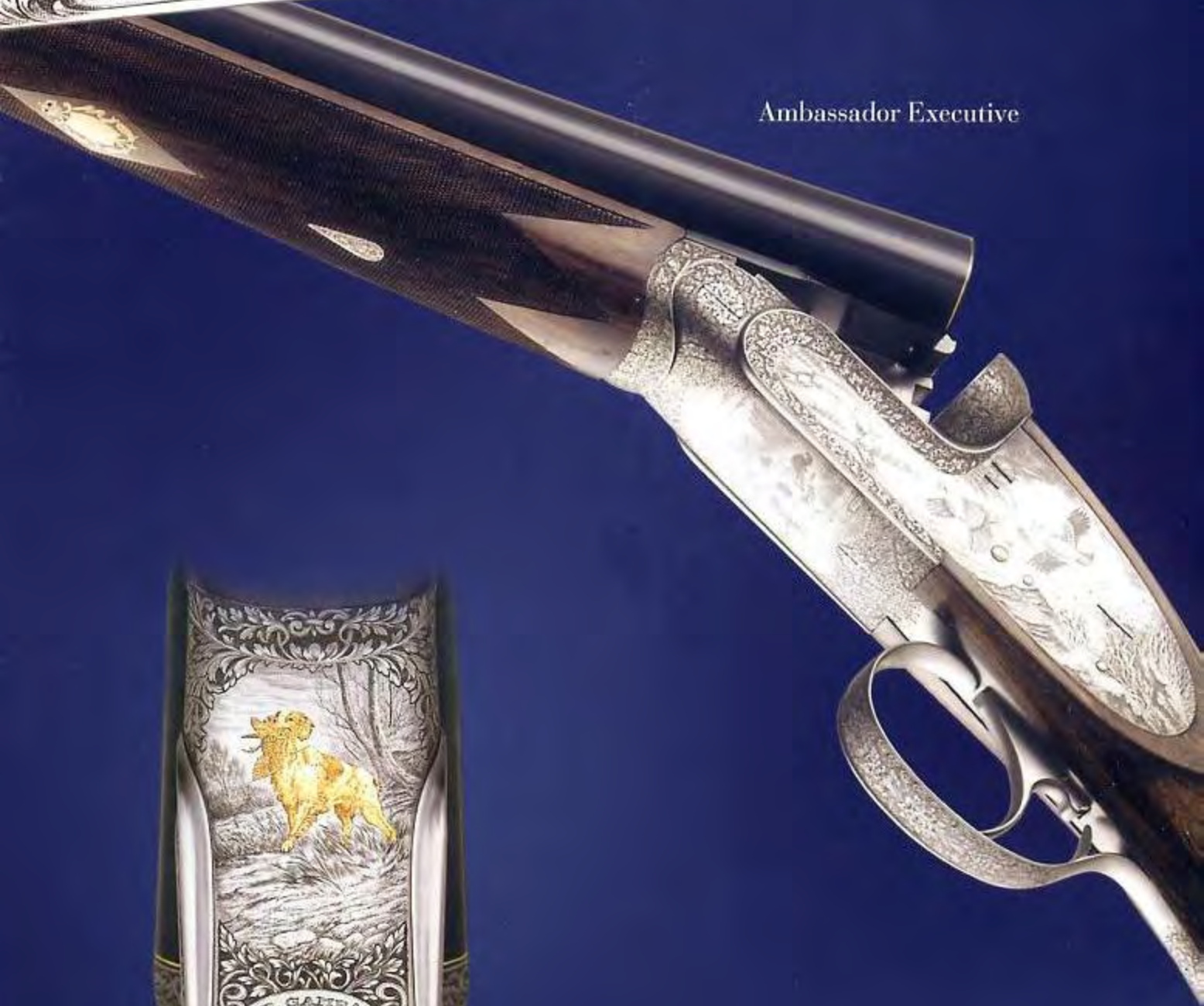



Daytona Expressly for you

The Boss type locking system and the action body over and under produced by Renato Gamba guarantee a very strong, durable and safe type firearm.

Nothing is therefore more natural than to develop a mid range caliber express rifle designed around these actions bodies and locking systems.

The excellent craftsmanship and natural pointability of these guns makes them inherently accurate and a natural choice for a quick handling big game rifle.

Able craftsmen combine the "Boss" locking system with a barrel length of 24 inches and regulate the coincidence of the impact point. During this regulation of the point of impact the aim is adjusted with an under-cut sight. If requested, the customer may choose to have an optical sight installed and regulated to point of impact.

The pistol grip stocks are of select walnut and are suitably hand checkered.

The Daytona has the classic removable trigger group (leaf springs if so desired) and features a **double safety system**, patented by Gamba.

The Daytona Express is offered in a basic version with sand blasted and chromed action bodies or polished with hand engravings of English scroll. At the customers option are available all types of engraving scenes as well





Daytona Express



Daytona Express

375 H&H, the 458 Winchester Magnum as well as the 458 Lott. As might be expected, both guns may be ordered with optional shotgun barrels in either 12 or 20 gauges. With the quickly interchangeable stocks these guns become very versatile indeed and are ready to cover any hunting situation.

as upgraded wood selections.

In addition to the removable trigger group, which is a great asset when hunting far away from home, is the selection of calibers.

The Daytona is available in .30.06, and 9.3x74R in the mid-range calibers and on the upper end for African hunting the immortal



Renato Gamba Mod. Maxim
con incisioni fuori serie

• Renato Gamba Maxim Double Rifle with
special order engraving by Galeazzi

Gamba Maxim Express

Being a magnificent side-by-side rifle for big game hunting, the Maxim Express is made by an enthusiast for enthusiasts. The extremely accurate chopper lump barrels are made of Böhler Rasant steel with a length of 24 inches. The barrels carry a full length hand filed rib with a fixed sight regulated for 50 meters and folding sights for 75, 100 and 125 meters. On demand we can also install a quick detachable optical sight adjusted to the customers wishes. The range of calibers for the Maxim are 375 H&H Magnum, 458 Winchester Magnum, 458 Lott and perhaps the best for dangerous game, the 470 Nitro Express. Calibers of such large size demand the up most in strength so we use the triple bite Purdey locking system with locking bolt under lugs and complete the ensemble with a Greener top lock. The entire action is made of hot forged hardened steel and finished by hand. The Maxim is only available with articulated double triggers so to protect the second finger on the shooters hand as he fires the second barrel. The pistol grip stock with cheekpiece and non-slip butt pad are made of only the finest walnut chosen for both its good looks and superior strength.





We use a beaver tail forend and checker both to perfection and finish with an oil or gloss finish.

A 24 karat gold shield is inlayed in the stock for the owner initials.

Acclaimed as one of the finest double rifles available the Maxim is renowned for its perfect balance and pointability. Add to this the many custom options available and it is easy to understand why. Options like hand game scene engravings by master engravers and you have a one of a kind masterpiece like the one pictured on these pages. This gun, engraved by Angelo Galeazzi with gold inlays, was produced for Safari Club International and auctioned at their 1989 annual convention in Reno Nevada. It realized the substantial sum of \$75,000.

- *Maxim Double Rifle with 24k gold inlays*



RENATO GAMBA™

*Gamba
Mustang
extra luxurious
Italian
workmanship*

Precision and lightness are the characteristics of this single shot break open rifle with one barrel. Tradition from the Austrian-German school, this rifle is a joy to hunt with.

With the Mustang Extra luxury the single shot break-open rifle reaches a new dimension, the one of a refined example of high arquebuser. Provided with a H&H style sidelock action with double safety system and double set triggers, this single shot rifle has a 25 inch barrel made of Böhler Rasant steel.

The barrel is completed with a special profile rib which carries an iron sight. Iron sights are seldom used on a rifle of this type so, as an option, we can install an optical sight in quick detachable mounts selected by the customer. The set trigger is set to break at a crisp 2 pounds to assure the accuracy to which this rifle is capable of.

The Mustang Extra is available in the following calibers, 7x65R, 6.5x57R, 243 Winchester, 270 Winchester and .30.06 Springfield.



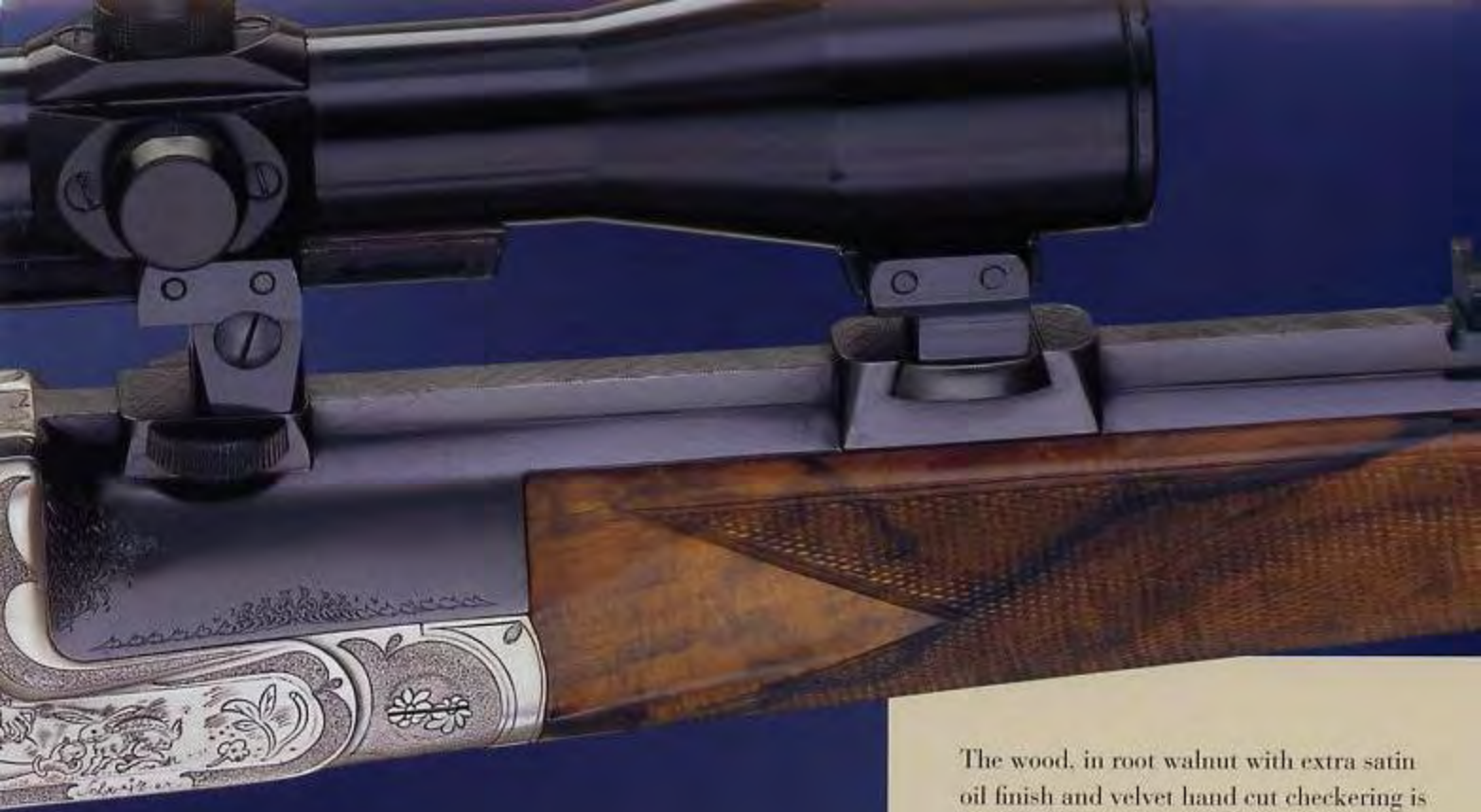

The wood, in root walnut with extra satin oil finish and velvet hand cut checkering is combined with traditional pistol grip stock and schnabel forend.

The engraving of the basic version offers an extremely refined motif but it is also possible to order the gun with custom game scene engraving of the client's choosing.

All of course are signed by master engravers. All of the guns shown here are of the special order type.



RENATO GAMBA™



Trident



Trident 1/1000



Mauser Gamba Hsc

*Pistols and
handguns
defend yourself
with elegance*

In addition to the range of fine shotguns and rifles, "Renato Gamba" also produces fine handguns. We offer calibers in 7.65 Browning and .380 auto for smaller pistols. In our revolver line we offer the time tested 38 Special. On these pages we have chosen to show some of the more artistic versions of our standard handguns. Many of the options available on these guns include gold inlay work, engraving, exotic grips and much more. It does not matter if the gun is highly decorated or of a standard nature the flawless workmanship and design remain the same.



RENATO GAMBA™

ISSF WORLD SHOTGUN CHAMPIONS

24th - 31st May 2005 - Lonato - I



Enrico Gamba Danka Bartekova (SVK) Anthony Terras (FRA) Jean Pierre Chavassieux (FRA) Abbey Burton (GBR) E

RENATO GAMBA TEAM



SHIP
taly



RENATO GAMBA™



Edward Ling (GBR) Aaron Heading (GBR)

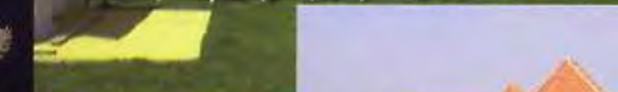

Gadget



1 T-Shirt

2 T-Shirt

3 T-Shirt

4 T-Shirt

5 Hat



Factory support



9



7



6



8



10



5

6 Shooting vest

7 ABS case

8 Leather case

9 Cap

10 Glasses

Technical specifications

MODEL	GAUGE / CHAMBER	BARREL (INCHES)	CHOKES	RIB	TRIGGER	TRIGGER GROUP	LOCKING SYSTEM
Concorde Trap	12-20	30-32 monobloc	imp.mod./full modified / full	flat / knurled / ventilated	single trigger (selective upon request)	Gamba patented	Boss type
Concorde SL	12-20/70	30-31-32 monobloc	imp.mod./full	flat / knurled / ventilated	single trigger (selective upon request)	Gamba patented	Boss type
Concorde Sporting Clays	12-20/70	27-28-30 monobloc	modified/full imp.cyl./imp.mod. interchangeable	flat / knurled / ventilated	single trigger (selective upon request)	Gamba patented	Boss type
Concorde Hunting / Skeet Round Body	12-20/70	27-28 monobloc	skeet/skeet	flat / knurled / ventilated	single trigger (selective upon request)	Gamba patented	Boss type
Daytona Trap K2	12-20/70	30-31-32 monobloc	imp.mod./full modified / full	flat / knurled / ventilated	single selective trigger and adjust. trigger upon request	detachable, removable by hand, interchangeable	Boss type
Daytona Double Trap K2	12-20/70	30-32 monobloc	imp.cyl./full	flat / knurled / ventilated	single selective trigger and adjust. trigger upon request	detachable, removable by hand, interchangeable	Boss type
Daytona Skeet K2	12-20/70	27-28 monobloc	cyl./cyl.	flat / knurled / ventilated	single selective trigger and adjust. trigger upon request	detachable, removable by hand, interchangeable	Boss type
Daytona Sporting Clays K2	12-20/70	28-29-30-32 monobloc	imp.mod./full interchangeable	flat / knurled / ventilated	single selective trigger	detachable, removable by hand, interchangeable	Boss type
Daytona Mono Trap K2	12-20/70	32-34 monobloc	full	flat / knurled / ventilated	single trigger	detachable, removable by hand, interchangeable	Boss type
Daytona Hunting	12-20/70	27-28 monobloc	modified/full imp.cyl./imp.mod. interchangeable	flat / knurled / ventilated	single selective trigger on request	detachable, removable by hand, interchangeable	Boss type
Daytona SL	12-20/70	monobloc or demibloc	chokes upon request	flat / knurled / ventilated	double, single, or single selective trigger	with sideplates	Boss type
Daytona SLHH	12-20/70	monobloc or demibloc	chokes upon request	flat / knurled / ventilated	double, single, or single selective trigger	sidelocks on patented Gamba plates	Boss type

MODEL	GAUGE / CHAMBER	BARREL (INCHES)	CHOKES	RIB	TRIGGER	TRIGGER GROUP	LOCKING SYSTEM
624 Prince ed Extra	12-20/70-76	25-27-28 monobloc	imp.cyl./imp.mod. modified / full	flat/knurled	double trigger, single trigger upon request	Anson type	double Purdey
New London	12-20/70-76	27-28 demibloc	imp.cyl./imp.mod. modified / full	flat/knurled	double or single trigger	sidelocks H&H type	three bite double Purdey
Gamba Mod. Ambassador	12-16-20 (70-76)	length upon request demibloc	upon request	flat/knurled	double or single trigger	Patented Gamba sidelocks linear movement hammer	three bite double Purdey

MODEL	CALIBER	BARREL (INCHES)	SIGHTS	SCOPE	TRIGGER	TRIGGER GROUP	LOCKING SYSTEM
O/U Daytona Express	30.06 9,3x74R 375 H&H	23 1/4 - 25 monobloc	"V" middle sight	installation and zeroing of the scope chosen by the customer, welded mounts	single trigger	detachable, removable by hand, interchangeable	Boss type
Side by side Maxim Express Gamba	30.06 9,3x74R 375 H&H 458 W. M. 458 Lotf. 470 N. E.	25 demibloc	fixed "V" middle sight zeroed at 50 M.+ 3 folding leafs for 75-100 and 125 M.	installation and zeroing of the scope chosen by the customer, welded mounts	double trigger with hinged first trigger	sidelocks patented Gamba, with linear movement hammer	three bite double Purdey and triple Greener lock-up
Mustang single barrel break-open rifle	243 Win. 6,5x57R 7x65 30.06	24 1/2 - 25 1/2 demibloc	fixed "V" middle sight	installation and zeroing of the scope chosen by the customer, welded mounts	with stecher	H&H type sidelocks	crossbolt on lugs and triple Greener lock-up

Over & under shotguns

STOCK	FOREND	APPROX. WEIGHT LBS
pistol grip, selective walnut, hand checkering, wax finish	beavertail	8.1
pistol grip, selective walnut, hand checkering, wax finish	schnabel	8.1
pistol grip, selective walnut, hand checkering, wax finish	schnabel	7.7
pistol grip or English style, selective walnut, hand checkering, wax finish	schnabel schnabel	6.8 7.8
anatomie pistol grip, Montecarlo optional, selected walnut, hand checkering, oil finish	beavertail	8.1
anatomie pistol grip, Montecarlo optional, selected walnut, hand checkering, oil finish	beavertail	8.1
anatomie pistol grip, Montecarlo optional, selected walnut, hand checkering, oil finish	special skeet	7.5
anatomie pistol grip, Montecarlo optional, selected walnut, hand checkering, oil finish	schnabel	7.7
anatomie pistol grip, with Montecarlo, selected walnut, hand checkering, oil finish	beavertail	8.1
pistol grip or English style, selected walnut hand checkering, wax finish	schnabel	6.9
pistol grip or English style, root, hand checkering, high gloss hand finish	schnabel	varying according to the version
pistol grip or English style, root, hand checkering, high gloss hand finish	schnabel	varying according to the version

All of our over and under shotguns are delivered in a hard style luggage case. The standard version is made of high impact resistant ABS which is perfect for travelling. The higher grade guns are delivered in a beautiful fitted leather case. All guns come with a tool to remove and tighten the stock. Stock dimensions of customer nature are always available and within a set range are available of stocks are available at slightly higher cost. Our spare trigger groups are available in either leaf or coil spring and to any engraving pattern. Interchangeable choke sets are available in sets of 5 units. Many different rib styles and stock styles are available, some at extra cost. All of guns are covered by our 3 year warranty. All of our Over-and-Under shotguns for game can be produced as a "pair" on customer's demand.

Specially manufactured side-by-side shotguns

STOCK	FOREND	APPROX. WEIGHT LBS
English style (pistol grip upon request), selected walnut, hand checkering, mat finish	standard	6.2 (12GA, 25" barrels) 6.0 (20GA, 27" barrels)
English style walnut root, hand checkering, mat finish	standard	6.8 (12 GA.)
English style or pistol grip, walnut root, hand checkering, oil finish	standard	6.8 (12 GA.)

All of the side-by-side shotguns made by Gamba are delivered in a hard luggage case. Remember all of these guns are of a custom nature and are therefore available with any options that the customer chooses. Please contact a dealer for any specific price quotes you may require. All of our side-by-side shotguns can be produced as a "pair" on customer's demand.

Express rifle

STOCK	FOREND	APPROX. WEIGHT LBS
pistol grip with cheekpiece, selected walnut, hand checkering, wax finish	schnabel	8.4
pistol grip with cheekpiece, selected root, hand checkering, high gloss hand finish	anatomic and roundwrapping	10.2
pistol grip with Montecarlo, walnut root, hand checkering, mat finish	schnabel	6.2

Express and single barrel are provided with a gun case - The Daytona Express features an adjustable forend iron in order to compensate the draft of the forend even after thousands shots fired. Stocks can be required, without overprice, with medium drops and lengths. Daytona Express delivered with patented Gamba double safety system.



RENATO GAMBA™

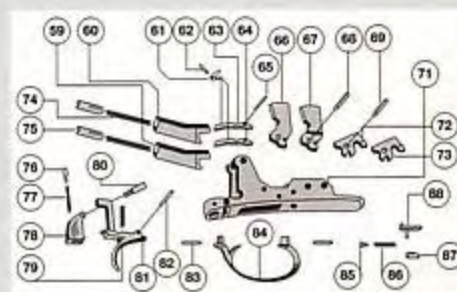
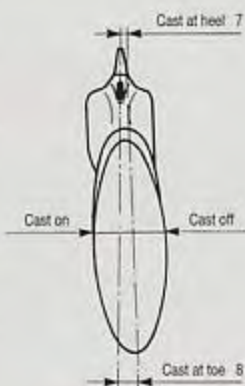
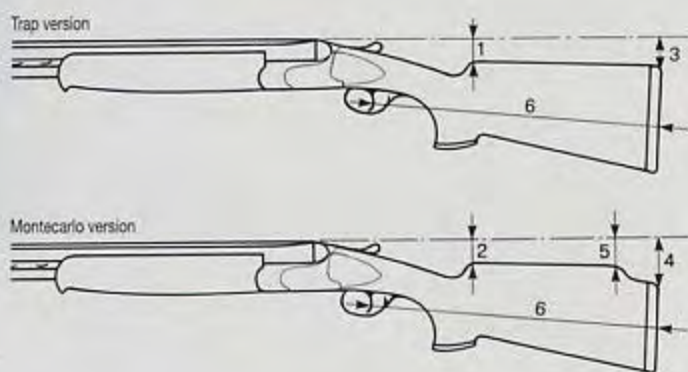
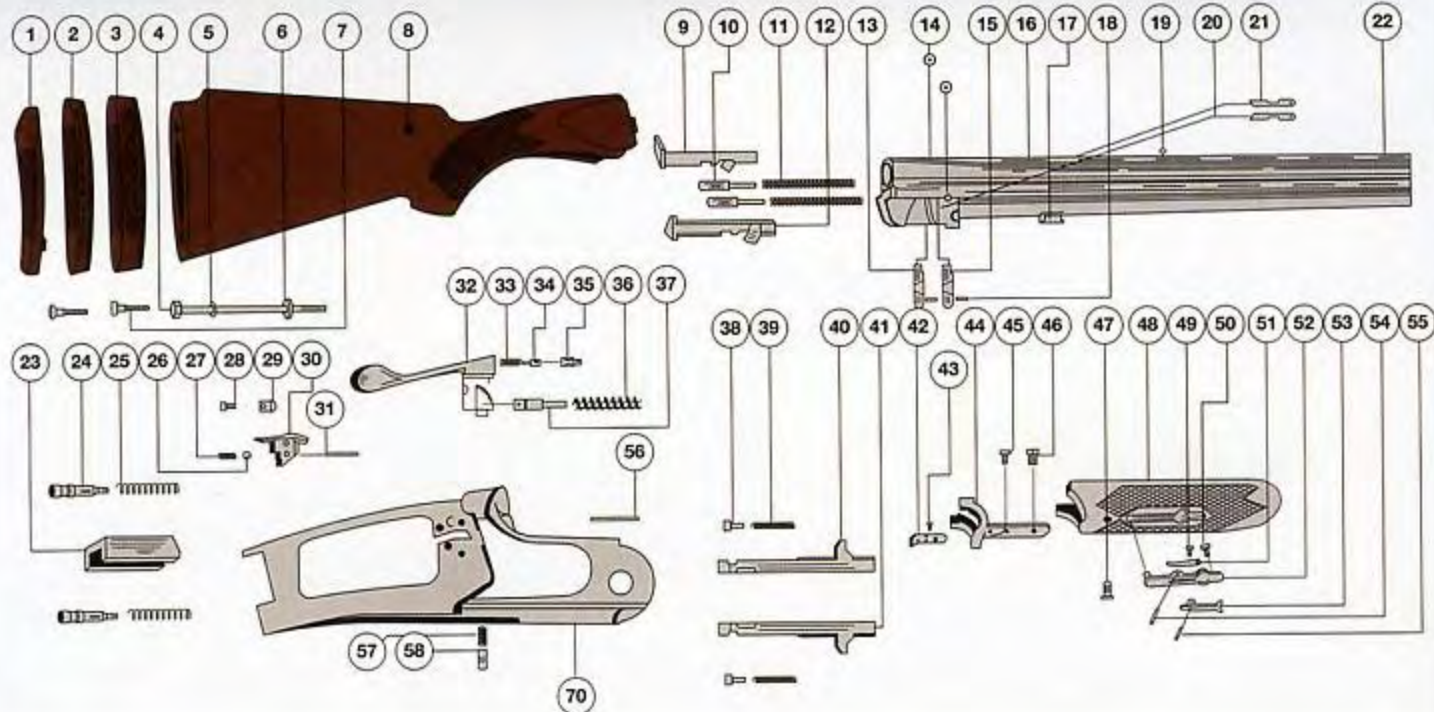

DAYTONA PARTS LIST

- | | | | |
|------------------------------------|---------------------------|--------------------------------|---------------------------------|
| 1 Plastic butt pad | 23 Action bolt | 45 Iron forend screw | 67 Right hammer |
| 2 Rubber butt pad | 24 Firing pin | 46 Forend catch screw | 68 Hammer pin |
| 3 Double ventilat. rubber butt pad | 25 Firing pin spring | 47 Iron forend screw nut | 69 Cocking toggle pin |
| 4 Stock bolt | 26 Safety sphere | 48 Forend | 70 Action frame |
| 5 Lock washer | 27 Safety spring | 49 Forend catch spring screw | 71 Trigger plate |
| 6 Stock bolt washer | 28 Safety catch screw | 50 Front forend catch screw | 72 Left cocking toggle pin |
| 7 Butt plate screw | 29 Safety catch | 51 Forend catch spring | 73 Right cocking toggle pin |
| 8 Stock | 30 Safety button | 52 Forend catch | 74 Hammer spring |
| 9 Left ejector | 31 Safety pin | 53 Forend catch lever | 75 Hammer spring pin |
| 10 Ejector guide spring | 32 Top lever | 54 Forend catch lever peg | 76 Equalizer spring pin |
| 11 Ejector spring | 33 Top lever catch spring | 55 Forend catch lever pin | 77 Equalizer spring |
| 12 Right ejector | 34 Top lever pin | 56 Firing pin pin | 78 Equalizer (Inertia block) |
| 13 Right ejector piston | 35 Top lever catch piston | 57 Cocking handle catch spring | 79 Trigger spring |
| 14 Ejector catch | 36 Top lever spring | 58 Cocking handle catch | 80 Equalizer peg |
| 15 Left ejector piston | 37 Top lever spring pin | 59 Right hammer spring guide | 81 Trigger |
| 16 Barrels | 38 Cocking handle pin | 60 Left hammer spring guide | 82 Trigger pin |
| 17 Forend rebiner | 39 Cocking handle spring | 61 Sear spring | 83 Trigger guard pin |
| 18 Ejector piston spring | 40 Left cocking handle | 62 Sear spring pin | 84 Trigger guard |
| 19 Middle sight | 41 Right cocking handle | 63 Left sear | 85 Sliding wedge screw |
| 20 Right ejector piston release | 42 Cocking cam | 64 Right sear | 86 Sliding wedge spring |
| 21 Left ejector piston release | 43 Cocking can screw | 65 Sear pin | 87 Sliding wedge |
| 22 Front sight | 44 Iron forend | 66 Left hammer | 88 Sliding wedge release button |



RENATO GAMBA™





BREMEC s.r.l.

Advanced Technologies System

Via Artigiani, 93 - 25063 Gardone Val Trompia Brescia Italy - Tel. +39 030 8910264 a.r. - Fax +39 030 8910265
e-mail: infocomm.@renatogamba.it - www.renatogamba.it

BREMEC is a Gamba Group Company

Il costruttore si riserva il diritto di apportare in qualunque momento e senza alcun preavviso, modifiche ai modelli descritti nel catalogo per ragioni di natura tecnica o commerciale.
The manufacturer reserves the right to modify for technical or commercial reasons, at any time and without notice, the specifications of the models illustrated in the catalogue.